

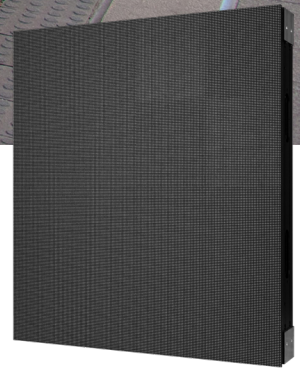

* All images in this datasheet are for illustrative purposes only.





Outdoor DVLED GSED Series

Eye-level Accessible DVLED

 Eye-level Pitch for Outdoor

 Design for Durability and Easy Maintenance

 Signal Redundancy Support

 Compatibility with LG Software Solutions

GSED

Pixel Pitch	2.50 mm
Brightness	4,000 nits
Weight per Cabinet	18.7 lbs. / 8.5 kg
Service Access	Front and Rear
IP Rating	IP66



Eye-level Pitch for Outdoor

Unlike the large-scale screens that are installed high above to ensure clear visibility, the GSED series has a smaller pixel pitch of 2.5 mm which allows eye-level accessibility to clearly display content on a smaller screen that is relatively close to the viewer.

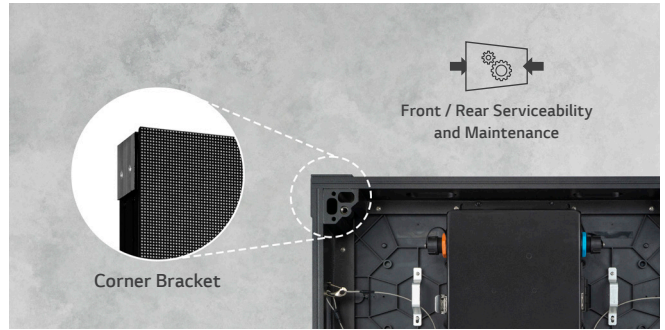

Design for Durability and Easy Maintenance

The GSED series corner brackets provide a solid installation and reduce the risk of twisting. Its accessibility from both the front and rear sides allows for easy maintenance for various installation environments.

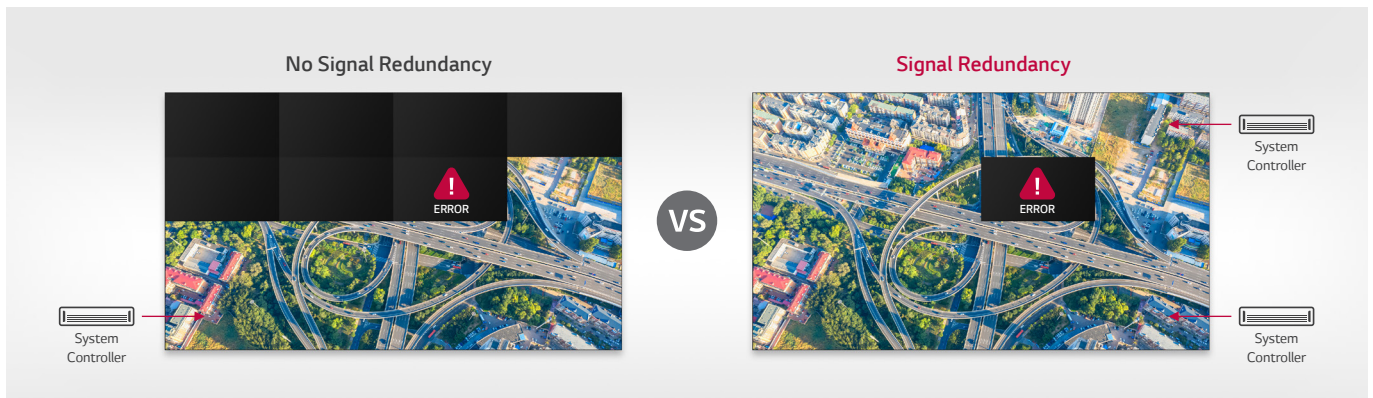

Signal Redundancy Support

The GSED series is designed to support signal redundancy. With an additional system controller, the dual controllers can facilitate reliable screen output even if one controller fails.*

* To use Signal redundancy properly, video transmission system has to be arranged suitably. Please check with an LG DVLED engineer to determine proper configuration.



Compatibility with LG Software Solutions

Powered by LG's high performance system controller, the LSAC series is compatible with LG software solutions including SuperSign CMS, LED Assistant, and ConnectedCare, which help customers have even more control over their systems.*

* LG ConnectedCare and LG SuperSign CMS are each sold separately. Actual user interface may vary in different webOS versions.

SPECIFICATIONS

GSED025-GD

Pitch Name		P2.50
Physical Parameters	Pixel Configuration	Single SMD
	Pixel Pitch (mm)	2.50
	Module Resolution (W x H)	96 x 108
	Module Dimensions (W x H, in. / mm)	9.4 x 10.6 / 240 x 270
	Weight per Module (lbs. / kg)	2.3 / 1.05
	No. of Modules per Cabinet (W x H)	2 x 2
	Cabinet Resolution (W x H)	192 x 216
	Cabinet Dimensions (W x H x D, in. / mm)	18.9 x 21.3 x 2.8 / 480 x 540 x 70
	Cabinet Surface Area (ft ² / m ²)	2.8 / 0.26
	Weight per Cabinet (lbs. / kg)	18.7 / 8.5
	Weight per Square Meter (lbs./ft ² / kg/m ²)	6.7 / 32.7
	Physical Pixel Density (pixels/m ²)	160,000
	Flatness of Cabinet (mm)	±1.0
	Cabinet Material	Al
	Service Access	Front and Rear
Optical Specifications	Max Brightness (After Calibration, nits)	4,000
	Color Temperature (K)	3,500-8,500
	Visual Viewing Angle (H x V)	160° x 140°
	Brightness Uniformity	97%
	Color Uniformity	±0.05 Cx, Cy
	Contrast Ratio	4,000 : 1
	Processing Depth (bit)	16 (HDR10, HDR10 Pro)
Electrical Specifications	Power Consumption (W/Cabinet, Max.)	180
	Power Consumption (W/Cabinet, Avg.)	72
	Power Consumption (W/m ² , Max.)	694
	Heat Dissipation (BTU/h/Cabinet, Max.)	614
	Heat Dissipation (BTU/h/Cabinet, Avg.)	246
	Heat Dissipation (BTU/h/m ² , Max.)	2,368
	Power Supply (Vac)	100 to 240
	Frame Rate (Hz)	50 / 60
	Refresh Rate (Hz)	3,840
Operation Specifications	LED Lifetime (Half Brightness)	Up to 100,000 hours
	Operating Temperature (°F / °C)	-22 to 122 / -30 to 50
	Operating Humidity	0-90% RH
	IP Rating Front / Rear	IP66 / IP66
Warranty	3 Year Limited	
Certification	CE / FCC / ETL	
Environment	RoHS, REACH	
Controller	CVEA	

* Specifications are subject to change without notice. Please make sure to check the product manual for details about product usage.